

Illustrated Index

⚠ WARNING System is under high pressure when engine is hot. To avoid danger of releasing scalding engine coolant, remove cap only when engine is cold.

Total Cooling System Capacity (Including heater and reservoir):

Manual transmission: 8.8 ℓ (9.3 US qt, 7.7 Imp qt)

Automatic transmission: 8.7 ℓ (9.2 US qt, 7.7 Imp qt)

NOTE:

- Check all cooling system hoses for damage, leaks or deterioration and replace if necessary.
- Check all hose clamps and retighten if necessary.
- Use new O-rings when reassembling.

RADIATOR

Engine coolant refilling and bleeding, page 10-6

Leak testing, page 10-7

Inspect soldered joints and seams for leaks.

Blow dirt out from between core fins with compressed air. If insects, etc., are clogging radiator, wash them off with low pressure water.

RADIATOR CAP

Pressure testing, page 10-7

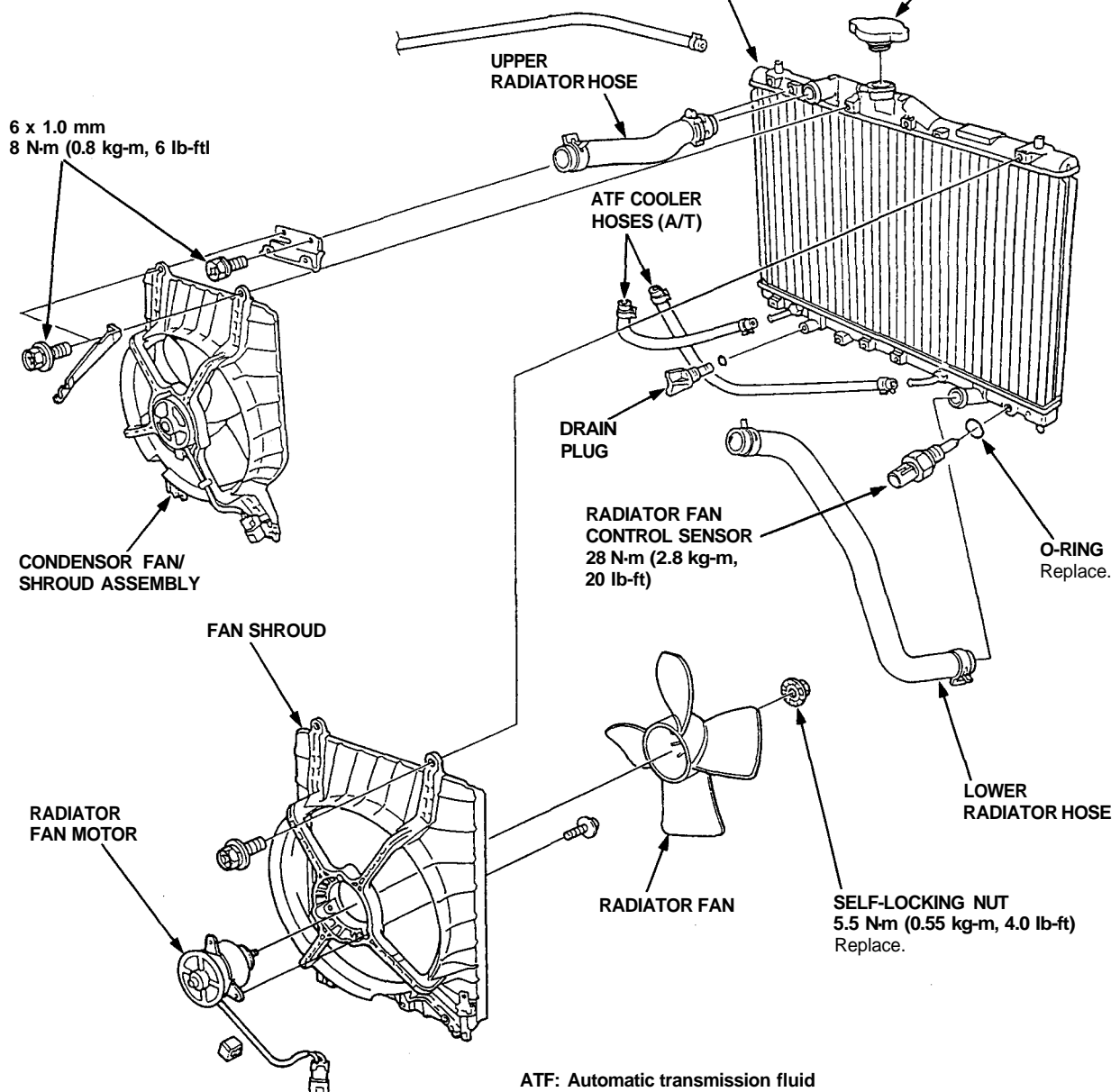



ENGINE COOLANT HOSE CONNECTIONS

GS model:

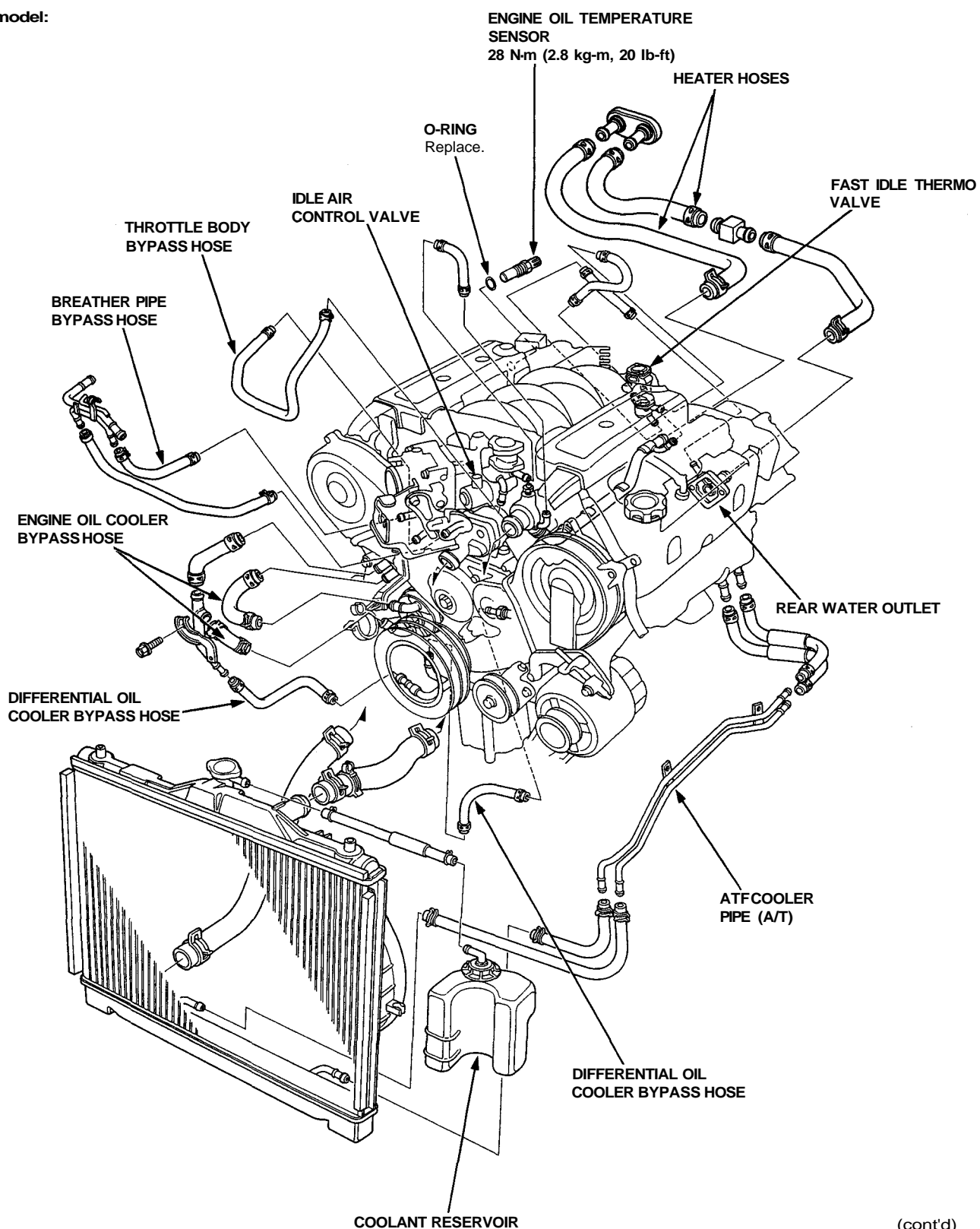

(cont'd)

Illustrated Index

(cont'd)

ENGINE COOLANT HOSE CONNECTIONS

Except GS model:

